

## Continental Plaza

180 East Broad Street, Suite 200  
Columbus, Ohio



*For further information:*

Wayne Harer 614.883.1051

[wharer@continental-realestate.com](mailto:wharer@continental-realestate.com)

### SUBLEASE OPPORTUNITY!

- 4,500 sf on the 2<sup>nd</sup> Floor
- Beautiful built-out offices
- Sublease thru 2/28/2012
- Available Immediately
- \$15.00/ sf Gross

### Property Details

- Newly renovated lobby
- Excellent views of Downtown Columbus
- Access to public transportation and major freeways
- Deli-café in lobby with available catering
- ATM machine
- Close proximity to shopping and hotels
- Heated, covered executive parking garage
- Attended, two-bay loading dock
- On-site management
- On-site engineering
- On-site 24 hour security

# Continental Plaza

180 East Broad Street, Suite 200  
Columbus, Ohio

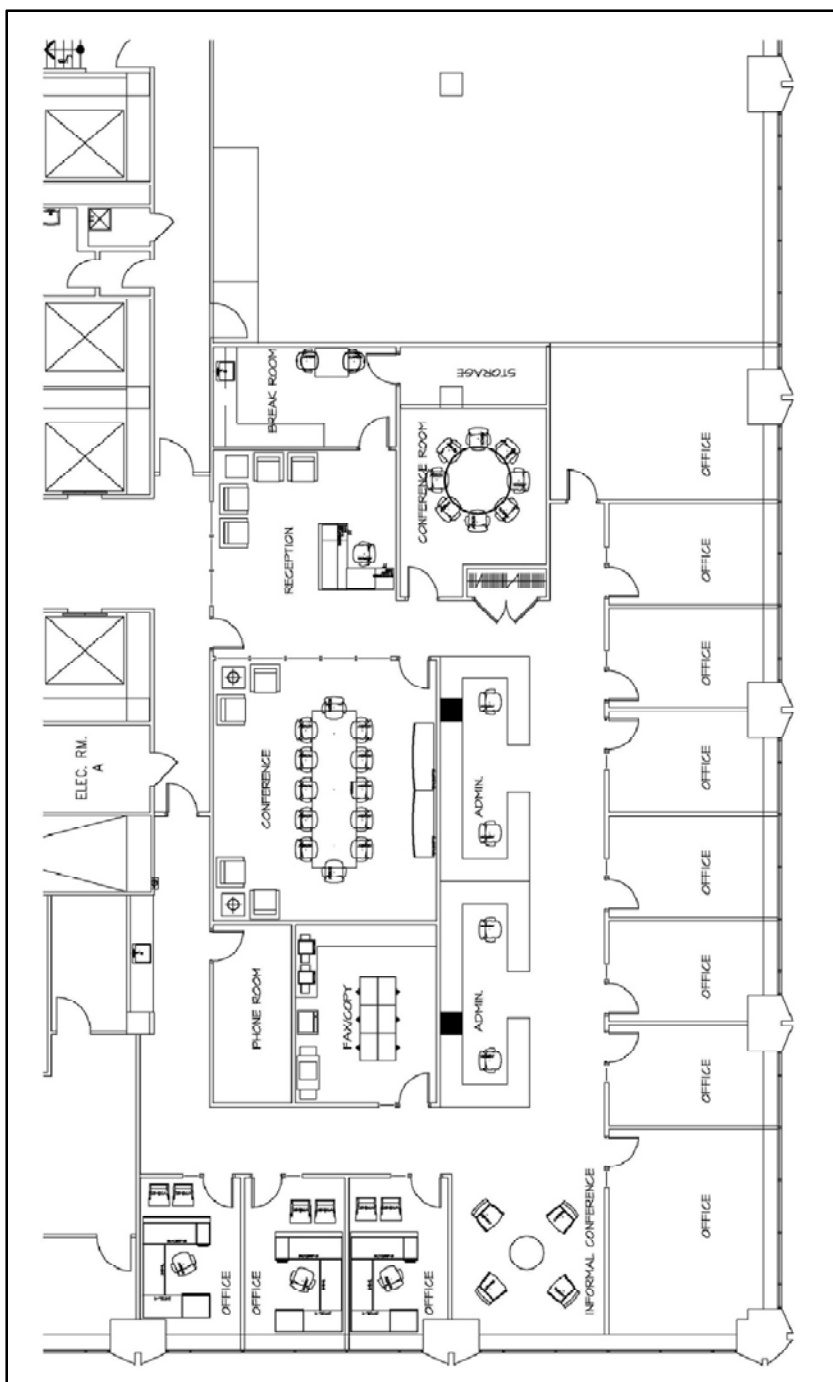

All information furnished regarding property for sale or lease is from sources deemed reliable, but no warranty or representation is made as to the accuracy thereof and same is submitted subject to errors, omissions, or other conditions, prior sale or lease, or withdrawal from market without notice.